

SAMSUNG

LED TV

user manual

SERIES4

Figures and illustrations in this User Manual are provided for reference only and may differ from actual product appearance. Product design and specifications may be changed without notice.

Still image warning

- Avoid displaying still images (like jpeg picture files) or still image element (like TV programme logo, panorama or 4:3 image format, stock or news bar at screen bottom etc.) on the screen. Constant displaying of still picture can cause ghosting of LED screen, which will affect image quality. To reduce risk of this effect, please follow below recommendations:
- Avoid displaying the same TV channel for long periods.
  - Always try to display any image on full screen, use TV set picture format menu for best possible match.
  - Reduce brightness and contrast values to minimum required to achieve desired picture quality, exceeded values may speed up the burnout process.
  - Frequently use all TV features designed to reduce image retention and screen burnout, refer to proper user manual section for details.

For India Only

This product is RoHS compliant.

Correct Disposal of This Product (Waste Electrical & Electronic Equipment)  
This marking on the product & accessories literature indicates that the product and its electronic accessories (e.g. charger, headset, USB cable) should not be disposed of with other household waste at the end of their working life. To prevent possible harm to the environment or human health from uncontrolled waste disposal, please separate these items from other types of waste and recycle them responsibly to promote the sustainable reuse of material resources. House hold users should contact either the retailer where they purchased this product, or their local government office, for details of where and how they can take these items for environmentally safe recycling. Business user should contact their supplier and check the terms and conditions of the purchase contract. This product and its electronic accessories should not be mixed with other commercial wastes for disposal.

For more information on safe disposal and recycling visit our website [www.samsung.com/in](http://www.samsung.com/in) or contact our helpline number - 18003669282, 180030008282

For personal and non-commercial use only.  
Usage is subject to following the guidelines in the User Manual and may not be available in all regions.



BN68-06310J-02

Country	Customer Care Centre ☎	Web Site
AUSTRALIA	1300 362 603	<a href="http://www.samsung.com/au/support">www.samsung.com/au/support</a>
NEW ZEALAND	0800 SAMSUNG (0800 726 786)	<a href="http://www.samsung.com/nz/support">www.samsung.com/nz/support</a>
CHINA	400-810-5858	<a href="http://www.samsung.com/cn/support">www.samsung.com/cn/support</a>
HONG KONG	(852) 3698 4698	<a href="http://www.samsung.com/hk_en/support">www.samsung.com/hk_en/support</a> (English)
INDIA	1800 3000 8282 - Toll Free 1800 266 8282 - Toll Free	<a href="http://www.samsung.com/in/support">www.samsung.com/in/support</a>
INDONESIA	0800112888 021-56997777	<a href="http://www.samsung.com/id/support">www.samsung.com/id/support</a>
JAPAN	0120-327-527	<a href="http://www.samsung.com/jp/support">www.samsung.com/jp/support</a>
MALAYSIA	1800-88-9999	<a href="http://www.samsung.com/my/support">www.samsung.com/my/support</a>
PHILIPPINES	1-800-10-7267864 [PLDT] 1-800-8-7267864 [Globe landline and Mobile] 02-4222111 [Other landline]	<a href="http://www.samsung.com/ph/support">www.samsung.com/ph/support</a>
SINGAPORE	1800-SAMSUNG (726-7864)	<a href="http://www.samsung.com/sg/support">www.samsung.com/sg/support</a>
THAILAND	0-2689-3232 1800-29-3232	<a href="http://www.samsung.com/th/support">www.samsung.com/th/support</a>
TAIWAN	0800-32-9999	<a href="http://www.samsung.com/tw/support">www.samsung.com/tw/support</a>
VIETNAM	1 800 588 889	<a href="http://www.samsung.com/vn/support">www.samsung.com/vn/support</a>
GEORGIA	0-800-555-555	<a href="http://www.samsung.com/ge/support">www.samsung.com/ge/support</a>
ARMENIA	0-800-05-555	<a href="http://www.samsung.com/am/support">www.samsung.com/am/support</a>
AZERBAIJAN	088-55-55-555	<a href="http://www.samsung.com/az/support">www.samsung.com/az/support</a>
UZBEKISTAN	8-10-800-500-55-500	<a href="http://www.samsung.com/uz/support">www.samsung.com/uz/support</a>
KYRGYZSTAN	8-10-800-500-55-500	<a href="http://www.samsung.com/kg_ru/support">www.samsung.com/kg_ru/support</a>
TADJIKISTAN	8-10-800-500-55-500	<a href="http://www.samsung.com/tj/support">www.samsung.com/tj/support</a>
MONGOLIA	+7-800-555-55-55	<a href="http://www.samsung.com/mn/support">www.samsung.com/mn/support</a>
BELARUS	810-800-500-55-500	<a href="http://www.samsung.com/by/support">www.samsung.com/by/support</a>
MOLDOVA	0-800-614-40	<a href="http://www.samsuimg.com/md/support">www.samsuimg.com/md/support</a>
ALGERIA	021 36 11 00	<a href="http://www.samsung.com/dn_africa/support">www.samsung.com/dn_africa/support</a>
PAKISTAN	0800-Samsung (72678)	<a href="http://www.samsung.com/pk/support">www.samsung.com/pk/support</a>
TUNISIA	80-1000-12	<a href="http://www.samsung.com/tn_africa/support">www.samsung.com/tn_africa/support</a>

Important Safety Instructions

SAMSUNG

Warning! Important Safety Instructions

(Please read the safety instructions below before installing and using the product.)

CAUTION

RISK OF ELECTRIC SHOCK: DO NOT OPEN

CAUTION: TO REDUCE THE RISK OF ELECTRIC SHOCK, DO NOT REMOVE COVER (OR BACK). THERE ARE NO USER SERVICEABLE PARTS INSIDE. REFER ALL SERVICING TO QUALIFIED PERSONNEL.

This symbol indicates that high voltage is present inside. It is dangerous to make any kind of contact with any internal part of this product.

This symbol indicates that important literature concerning operation and maintenance has been included with this product.

- The slots and openings in the cabinet and in the back or bottom are provided for necessary ventilation. To ensure reliable operation of this apparatus, and to protect it from overheating, these slots and openings must never be blocked or covered.
  - Do not cover the slots and openings with a cloth or other materials.
  - Do not block the slots and openings by placing this apparatus on a bed, sofa, rug or other similar surface.
  - Do not place this apparatus in a confined space, such as a bookcase or built-in cabinet, unless proper ventilation is provided.
- Do not place this apparatus near or over a radiator or heat register, or where it is exposed to direct sunlight.
- Do not place a vessel containing water (kettle etc.) on this apparatus, as this can result in a risk of fire or electric shock.
- Do not expose this apparatus to rain or place it near water (near a bathtub, washbowl, kitchen sink, or laundry tub, in a wet basement, or near a swimming pool etc.). If this apparatus accidentally gets wet, unplug it and contact an authorized dealer immediately.
- Make sure to pull out the power cord from the outlet before cleaning.
- This apparatus uses batteries. In your community, there might be regulations that require you to dispose of these batteries properly to protect the environment. Please contact your local authorities for disposal or recycling information.
- Do not overload wall outlets, extension cords, or adapters beyond their capacity, since this can result in fire or electric shock.
- Power-supply cords should be routed so that they are not likely to be walked on or pinched by items placed upon or against them. Pay particular attention to cords at the plug end, where connected to adapters, and at the point where they exit from the apparatus.
- To protect this apparatus from a lightning storm, or when it is left unattended and unused for long periods of time, unplug it from the wall outlet and disconnect the antenna or cable system. This will prevent damage to the set due to lightning and power line surges.
- Before connecting the AC power cord to the DC adaptor outlet, make sure the voltage designation of the DC adaptor corresponds to the local electrical supply. (Depending on the model)
- Never insert anything metallic into the open parts of this apparatus. Doing so may create a danger of electric shock.
- To avoid electric shock, never touch the inside of this apparatus. Only a qualified technician should open this apparatus.
- Make sure to plug the power cord in until it is firmly inserted. Pull on the plug, not the cord, when removing the power cord from the outlet. Do not touch the power cord with wet hands.
- If this apparatus does not operate normally - in particular, if there are any unusual sounds or smells coming from it - unplug it immediately and contact an authorized dealer or service center.
- Be sure to pull the power plug out of the outlet if the TV is to remain unused or if you are to leave the house for an extended period of time (especially when children, elderly or disabled people will be left alone in the house).
  - Accumulated dust can cause an electric shock, an electric leakage, or a fire by causing the power cord to generate sparks and heat, or cause the insulation to deteriorate.
- Be sure to contact an authorized service center, when installing your set in a location with heavy dust, high or low temperatures, high humidity, chemical substances or where it will operate for 24 hours a day such as in an airport, a train station, etc. Failure to do so may cause serious damage to your set.
- Use only a properly grounded plug and receptacle.
  - An improper ground may cause electric shock or equipment damage. (Class I Equipment only.)
- To turn off the apparatus completely, you must pull the power plug out of the wall socket. Consequently, the power plug should be readily accessible at all times.
- Do not allow children to hang onto the product.
- Store the accessories (batteries, etc.) in a location safely out of the reach of children.
- Do not install the product in an unstable location such as a shaky wall, a slanted floor, or a location exposed to vibration.
- Do not drop or impart a shock to the product. If the product is damaged, disconnect the power cord and contact a service center.
- To clean the product, unplug the power cord from the power outlet and wipe the product using a soft, dry cloth. Do not use any chemicals such as wax, benzene, alcohol, thinners, insecticides, air freshener, lubricant or detergent. This may damage the appearance or erase the printing on the product.
- Do not expose the apparatus to dripping or splashing.
- Do not dispose of batteries in a fire.
- Do not short circuit, disassemble, or overheat the batteries.
- Do not short circuit, disassemble, or overheat the batteries.
- There is a danger of explosion if you replace the batteries with the wrong type of battery. Replace only with the same or equivalent type.
- WARNING - TO PREVENT THE SPREAD OF FIRE, KEEP CANDLES OR OTHER OPEN FLAMES AWAY FROM THIS PRODUCT AT ALL TIMES.

Getting Started

Accessories

- Remote Control & Batteries (AAA x 2)
- Owner's Instructions
- Warranty Card / Regulatory Guide (Not available in some locations)
- Power Cord

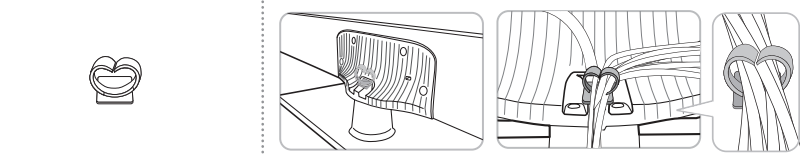

- Cable Holder (1EA)

Input Cables (Sold Separately)

- Composite (AV)
- Component
- Coaxial (RF)
- HDMI
- HDMI-DVI

TV Controller (Panel Key)

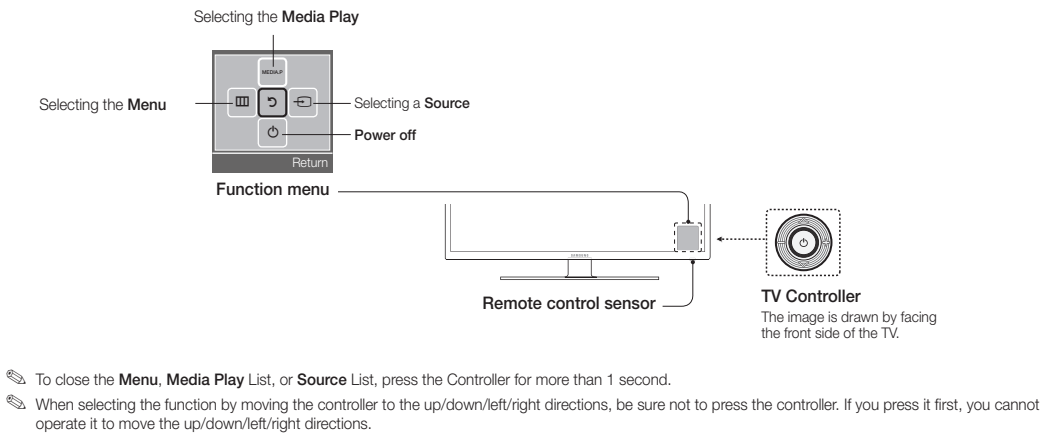

- ☞ To close the **Menu**, **Media Play** List, or **Source** List, press the Controller for more than 1 second.
- ☞ When selecting the function by moving the controller to the up/down/left/right directions, be sure not to press the controller. If you press it first, you cannot operate it to move the up/down/left/right directions.

Plug & Play (Initial Setup)

- When you turn the TV on for the first time, a sequence of screens and on-screen prompts will assist you in configuring the TV's basic settings. Plug the power cord into a wall outlet, and then press the **POWER** button to turn on the TV. Set the initial setup following instructions that the TV guides.
- ☞ If you are not using a cable box or satellite box, make you sure have connected the TV to an Aerial or cable connection before you turn on the TV.
  - ☞ Connecting the power cord and antenna. (refer to 'Connections')

Connections

- For better picture and audio quality, connect to a digital device using an HDMI cable.
- The picture may not display normally (if at all) or the audio may not work if an external device that uses an older version of HDMI mode is connected to the TV. If such a problem occurs, ask the manufacturer of the external device about the HDMI version and, if out of date, request an upgrade.
- Be sure to purchase a certified HDMI cable. Otherwise, the picture may not display or a connection error may occur.
- **PC/DVI AUDIO IN** input is not supported.
- For HDMI/DVI cable connection, you must use the HDMI IN 2 (DVI) port.
- Connecting through the HDMI cable may not be supported depending on the PC.
- If an HDMI to DVI cable is connected to the HDMI IN 2 (DVI) port, the audio does not work.
- For Set-top box connection using HDMI cable, we highly recommend you to connect the HDMI IN 1 (STB) port.

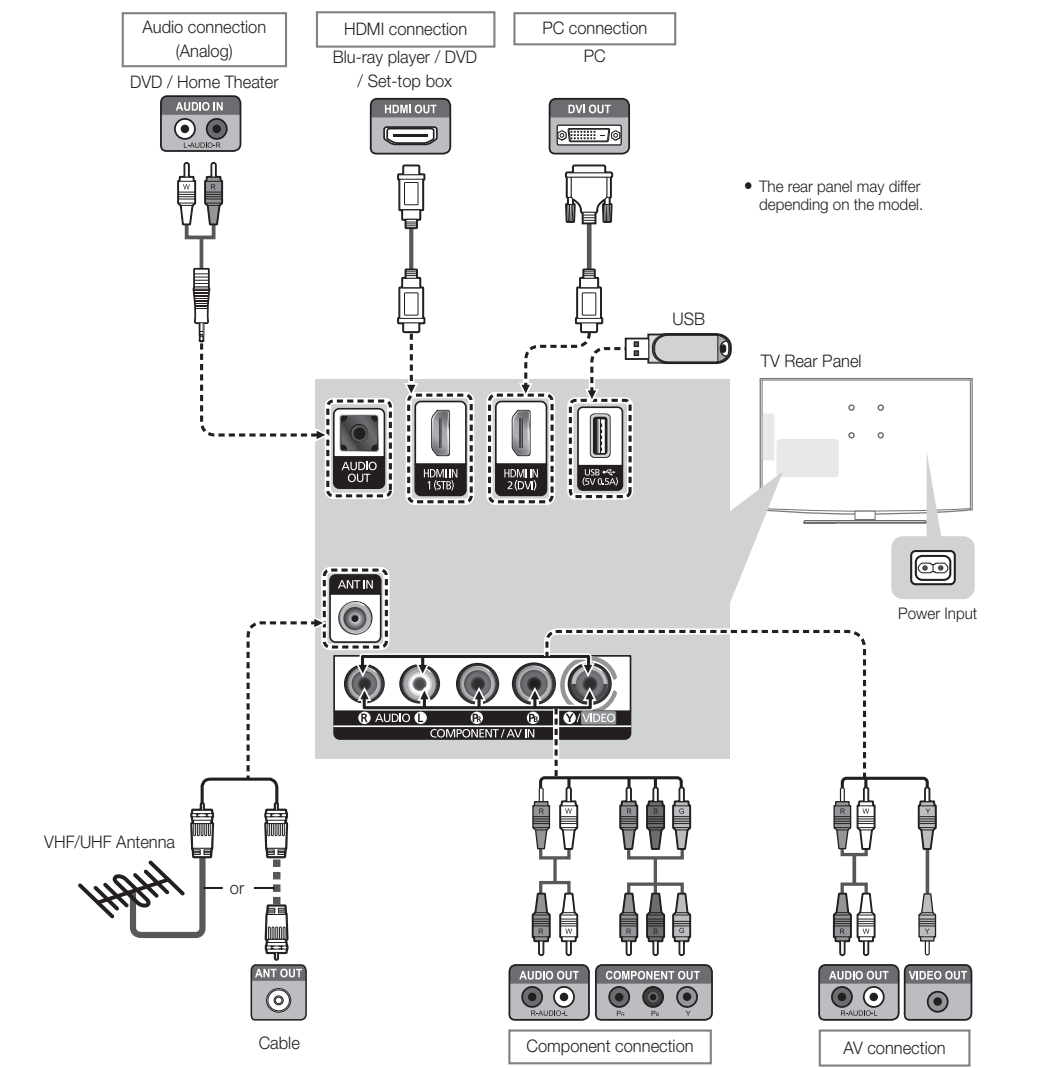

Changing the Input Source

Source List

- Use to select TV or other external input sources such as DVD / Blu-ray players / cable box / STB satellite receiver connected to the TV.
1. Press the **SOURCE** button.
  2. Select a desired external input source.

■ TV / AV / Component / HDMI1 / HDMI2/DVI

- ☞ You can only choose external devices that are connected to the TV. In the **Source List**, connected inputs will be highlighted.

How to use Edit Name

Edit Name lets you associate a device name to an input source. To access **Edit Name**, enter **Support** menu and select **Edit Name**. Name the device connected to the input jacks to make your input source selection easier.

- ☞ When connecting a TV to the HDMI IN 2 (DVI) port with HDMI cable, you should set the TV to **PC** mode under **Edit Name**.
- ☞ When connecting a PC to the HDMI IN 2 (DVI) port with HDMI to DVI cable, you should set the TV to **DVI PC** mode under **Edit Name**.
- ☞ When connecting an AV device to the HDMI IN 2 (DVI) port with HDMI to DVI cable, you should set the TV to **DVI** mode under **Edit Name**.

Information

- Press **INFO** (i), you can see detailed information about the selected external device.
- ☞ **Information** only available for the current connected source.

Display Modes (HDMI/DVI Input)

Optimal resolution							
4 series: 1366 x 768@60Hz / 5 series: 1920 x 1080@60Hz							
Mode	Resolution	Horizontal Frequency [Hz]	Vertical Frequency [Hz]	Pixel Clock Frequency [MHz]	Sync Polarity (H / V)	1366 x 768	1920 x 1080
IBM	720 x 400	31.469	70.087	28.322	-/+	✓	✓
	640 x 480	35.000	60.667	30.240	-/-	✓	✓
	832 x 624	49.726	74.551	67.284	-/-	✓	✓
	1152 x 870	68.661	75.062	100.000	-/-	✓	✓
MAC	640 x 480	31.469	59.940	25.175	✓	✓	✓
	640 x 480	37.861	72.839	31.500	✓	✓	✓
	640 x 480	37.500	75.000	31.500	✓	✓	✓
	800 x 600	37.879	60.317	40.000	+/-	✓	✓
VESA DMT	800 x 600	48.077	72.188	50.000	+/-	✓	✓
	800 x 600	48.875	75.000	49.500	+/-	✓	✓
	1024 x 768	48.363	60.004	65.000	-/-	✓	✓
	1024 x 768	56.476	70.069	75.000	✓	✓	✓
	1024 x 768	60.023	75.029	78.750	+/-	✓	✓
	1152 x 864	67.500	75.000	108.000	+/-	✓	✓
	1280 x 720	45.000	60.000	74.250	+/-	✓	✓
	1280 x 800	49.702	59.810	83.500	-/-	✓	✓
	1280 x 1024	63.981	60.020	108.000	+/-	✓	✓
	1280 x 1024	79.976	75.025	135.000	+/-	✓	✓
	1366 x 768	47.712	59.790	85.500	+/-	✓	✓
	1440 x 900	55.935	59.887	106.500	-/-	✓	✓
	1600 x 900FB	60.000	60.000	108.000	+/-	✓	✓
	1680 x 1050	65.290	59.954	146.250	✓	✓	✓
	1920 x 1080	67.500	60.000	148.500	+/-	✓	✓

Installing batteries (Battery size: AAA)

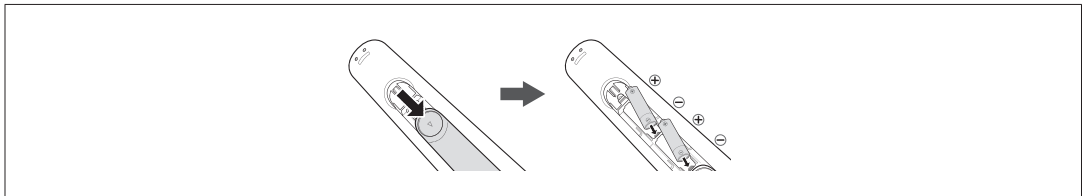

- ☞ **NOTE**
- Use the remote control within 23 feet from TV.
  - Bright light may affect the performance of the remote control. Avoid using nearby special fluorescent light or neon signs.
  - The Colour and shape may vary depending on the model.

Channel Menu

Seeing Channels

Channel List

Select a channel in the **All Channels**, **Added Channels** screen by pressing the **▲/▼** buttons, and pressing the **ENTER** (⏏) button. Then you can watch the selected channel.

- ☞ Using the remote control buttons with the **Channel List**.

Channel Status Display icons

Icons	Operations
	A channel deleted.

Retuning Channels

Area

You can change the desired area.

Auto Store

(Depending on the country)  
Scans for a channel automatically and stores in the TV.

Manual Store

Scans for a channel manually and stores in the TV.

- ☞ According to channel source, **Manual Store** may be supported.
- ☞ **Programme**, **Colour System**, **Sound System**, **Channel**, **Search**, **Store**: If there is abnormal sound or no sound, reselect the sound standard required.

Channel List Option Menu

Set each channel using the **Channel List** menu options (**Add** / **Delete**). Option menu items may differ depending on the channel status.  
Set each channel using the **Channel List** menu options. Option menu items may differ depending on the channel status.

- **Add / Delete**: Delete or add a channel to display the channels you want.
  - ☞ All deleted channels will be shown on the **All Channels** menu.
  - ☞ A "X" beside the channel indicates the channel has been deleted.
  - ☞ The **Add** menu only appears for deleted channels.

Fine Tune

If the reception is clear, you do not have to fine tune the channel, as this is done automatically during the search and store operation. If the signal is weak or distorted, fine tune the channel manually.

- ☞ Fine tuned channels that have been saved are marked with an asterisk "\*" on the right-hand side of the channel number in the channel banner.
- ☞ This is available for analogue broadcasts only.

Picture Menu

Picture Mode **TOOLS**

Select your preferred picture type.

- **Dynamic**: Suitable for a bright room.
- **Standard**: Suitable for a normal environment.
- **Movie**: Suitable for watching movies in a dark room.

Backlight / Contrast / Brightness / Sharpness / Colour / Tint (G/R)

Your television has several setting options for picture quality control.

- ☞ In analogue **TV**, **AV** modes of the PAL system, the **Tint** (G/R) function is not available.
- ☞ When connecting a PC, you can only make changes to **Backlight**, **Contrast**, **Brightness** and **Sharpness**.
- ☞ Settings can be adjusted and stored for each external device connected to the TV.
- ☞ Lowering picture brightness reduces power consumption.

Picture Options

- **Colour Tone**: Select the colour temperature
  - ☞ **Warm** will be deactivated when the picture mode is **Dynamic**.
- **Size**: Your cable box/satellite receiver may have its own set of screen sizes as well. However, we highly recommend you use 16:9 mode most of the time.
  - 4:3: Sets the picture to basic (4:3) mode.
  - Zoom1/Zoom2: Zoom out 16:9 wide mode vertically to fit the screen size.
  - ☞ Do not watch in 4:3 format for a long time. Traces of borders displayed on the left, right and centre of the screen may cause image retention (screen burn) which are not covered by the warranty.
- ☞ **Screen Fit**: Displays the full image without any cut-off when HDMI/720p/1080i/1080p signals are inputted.
- ☞ **NOTE**
  - Depending on the input source, the picture size options may vary.
  - The available items may differ depending on the selected mode.
  - Settings can be adjusted and stored for each external device connected to an input on the TV.

- **Digital Clean View**: (Auto / Off / Low / Medium / High) If the broadcast signal received by your TV is weak, you can activate the **Digital Clean View** feature to reduce any static and ghosting that may appear on the screen.
  - ☞ When the signal is weak, try other options until the best picture is displayed.

- **HDMI Black Level**: Selects the black level on the screen to adjust the screen depth.
  - ☞ Available only in **HDMI** mode (RGB signals).

- **Film Mode**: (Auto / Off) Sets the TV to automatically sense and process film signals from all sources and adjust the picture for optimum quality.
  - ☞ Available in TV mode, AV, COMPONENT (480i / 1080i) and HDMI (480i / 1080i).

- **Motion Lighting**: Reduce power consumption by brightness control adapted motion.
  - ☞ Only available in **Standard** mode.

Picture Reset

Resets your current picture mode to its default settings.

- **Reset Picture Mode**: Returns all picture values in the currently.

Sound Menu

Sound Mode **TOOLS**

- **Standard**: Selects the normal sound mode.
- **Music**: Emphasizes music over voices.
- **Movie**: Provides the best sound for movies.
- **Clear Voice**: Emphasizes voices over other sounds.

Equalizer

(standard sound mode only)

- **Balance**: Adjusts the balance between the right and left speaker.
- **100Hz / 300Hz / 1kHz / 3kHz / 10kHz (Bandwidth Adjustment)**: Adjusts the level of specific bandwidth frequencies.
- **Reset**: Resets the **Equalizer** to its default settings.

- ☞ If the stereo signal is weak and an automatic switching, occurs, then switch to the mono.
- ☞ Only activated in stereo sound signal.
- ☞ This function is available for all input sources.

DTS TruSurround **TOOLS**

(standard sound mode only)  
This function provides a virtual 5.1 channel surround sound experience through a pair of speakers using HRTF (Head Related Transfer Function) technology.

Auto Volume

Because each broadcasting station has its own signal conditions, the volume may fluctuate each time channel is changed. This feature lets you automatically adjust the volume of the desired channel by lowering the sound output when the modulation signal is high or by raising the sound output when the modulation signal is low.

Speaker Select

A sound echo may occur due to a difference in decoding speed between the main speaker and the audio receiver. In this case, set the TV to **External Speaker**.

- ☞ When you set **Speaker Select** to **External Speaker**, the TV's speakers are turned off. You will hear sound through the external speakers only.
- ☞ When you set **Speaker Select** to **TV Speaker**, both the TV's speakers and the external speakers are on. You will hear sound through both.

- ☞ When **Speaker Select** is set to **External Speaker**, the volume and MUTE buttons will not operate and the sound settings will be limited.
- ☞ If there is no video signal, both speakers will be mute.

Sound Reset

- **Reset All**: Reset all sound settings to the factory defaults.

Selecting the Sound Mode **TOOLS**

When you set to **Dual I - Dual II**, the current sound mode is displayed on the screen.

	Audio Type	Dual I-II	Default
A2 Stereo	Mono	Mono	Automatic change
	Stereo	Stereo ↔ Mono	
	Dual	Dual I ↔ Dual II	Dual I
NICAM Stereo	Mono	Mono	Automatic change
	Stereo	Mono ↔ Stereo	
	Dual	Mono ↔ Dual I ∖ Dual II √	Dual I



## Setup Menu

### Language

Set the menu language.

- Press ◀ or ▶ button to select menu language. (According to the different areas, some countries have only one language.)

### Time

- The current time will appear every time you press the INFO button.

- Clock Set:** Set the Year, Month, Day, Hour, Minute.

#### ■ On Timer/Off Timer

- Current time should be set first by **Clock Set**.

**Repeat:** Set the timer to repeat by **Once, Everyday, Mon-Fri, Mon-Sat, Sat-Sun, Sun**.  
**Select Off** to turn of **Repeat**.  
**Hour/Minute:** Enter the hour and minute for the TV to turn on or off.  
**Contents:** Select TV.

**Channel:** Select the channel to be played when the TV turns on automatically.  
**Volume:** Select the volume level when TV turns on automatically.

#### ■ Sleep Timer **[TOOLS]**

Automatically shuts off the TV after a preset period of time. **(Off, 30 min, 60 min, 90 min, 120 min, 150 min and 180 min)**  
To cancel **Sleep Timer**, select **Off**.

### Melody

Set so that a melody plays when the TV is turned **Off, Low, Medium and High**.

- The **Melody** does not play.
- When no sound is output from the TV because the volume has been reduced to minimum with the VOL – button.
- When the TV is turned off by **Sleep Timer** function.

### Auto Power Off

The TV will be automatically turned off when no user operation is received for 4 hours.

- If the **Auto Power Off** option is set to **Off**, the TV will stay on even if no operations are performed on the TV.

## Support Menu

### □ Using the Media Play

Enjoy photos, music and/or movie files saved on a USB Mass Storage Class (MSC) device.



### Connecting a USB Device

- Turn on your TV.
- Connect a USB device containing photo, music and/or movie files to the USB jack on the side of the TV.
- When USB is connected to the TV, you can select **Media Play**.

- The maximum displayed number of partitions is 4.

### Using the Media Play Menu

- Press the MENU button. Press the ◀ or ▼ button to select **Support**, then press the ENTER button.
- Press the ▲ or ▼ button to select **Media Play (USB)**, then press the ENTER button.
- Press the ◀ or ▶ button to select an icon (**Videos, Music, Photos**), then press the ENTER button.
  - It might not work properly with unlicensed multimedia files.
  - If you want to view detailed information of the file being played, press **TOOLS** button in the file list, and then select **Information**.
  - Need-to-Know List before using **Media Play (USB)**
    - Supported file systems are FAT and NTFS.
    - Certain types of USB Digital camera and audio devices may not be compatible with this TV.

- Media Play** only supports USB Mass Storage Class (MSC) devices. MSC is a Mass Storage Class Bulk-Only Transport device. Examples of MSC are Thumb drives and Flash Card Readers. Devices should be connected directly to the TV's USB port. (USB HDD is not supported.) Does not support smart devices connected in MTP or PTP protocol.
- Before connecting your device to the TV, please back up your files to prevent them from damage or loss of data. SAMSUNG is not responsible for any data file damage or data loss.
- A USB device that requires high power (more than 0.5A) may not be supported.
- Do not disconnect the USB device while it is loading.
- The higher the resolution of the image, the longer it takes to display on the screen.
- The maximum supported JPEG resolution is 15360 x 8640 pixels.
- If a file is corrupted or the TV does not support the file type, the "Not Supported File Format." message appears.
- If a USB extension cable is used, the USB device may not be recognized or the files on the device may not be read.
- The TV cannot play MP3 files with DRM that have been downloaded from a for-pay site. Digital Rights Management (DRM) is a technology that supports the creation, distribution, and management of digital content in an integrated and comprehensive way, including protecting the rights and interests of content providers, preventing illegal copying of contents, and managing billings and settlements.

- PTP device is not supported.
- If an over-power warning message is displayed while you are connecting or using a USB device, the device may not be recognized or may malfunction.
- The power-saving mode of some external hard disk drives may be released automatically when you connect them to the TV.
- If a USB device connected to the TV is not recognized, the list of files on the device is corrupted, or a file in the list is not played, connect the USB device to a PC, format the device, and check the connection.
- If a file you deleted from the PC is still found when you run **Media Play**, use the "Empty the Recycle Bin" function on the PC to permanently delete the file.
- Photos** only supports sequential jpeg format.
- The scene search and thumbnail functions are not supported in the **Videos**.
- If the number of files and folders saved on a USB storage device is approximately over 4000, the files and folders may not appear and some folders may not be opened.
- The maximum displayed number of files, including sub folders, in one folder of USB storage device is 2000.
- The media may not be playing smoothly when using the device higher than USB 2.0.
- The file name only works in supported menu language. The other language is not displayed properly.

### ■ Videos

- Press the ◀ or ▶ button to select **Videos**, then press the ENTER button in the **Media Play** menu.
- Press the ◀▶/▲/▼ buttons to select the desired video in the file list.
- Press the ENTER button or [▶] (Play) button.
  - The selected file is displayed on the top with its playing time.
  - If video time information is unknown, playing time and the progress bar are not displayed.
  - During video playback, you can search using the ◀ and ▶ button.
  - You can use [◀] (REW) and [▶] (FF) buttons during playback.

- In this mode, you can play movie clips contained in a game, but you cannot play the game itself.

#### • Supported Subtitle Formats

##### - External

Name	File extension
MPEG-4 Timed text	.txt
SAV	.smi
SubRip	.srt
SubViewer	.sub
Micro DVD	.sub or .txt
SubStation Alpha	.ass
Advanced SubStation Alpha	.ass

##### - Internal

Name	Container	Format
Xvid	avi	Picture Format
SubStation Alpha	MKV	Text Format
Advanced SubStation Alpha	MKV	Text Format
SubRip	MKV	Text Format
MPEG-4 Timed text	MP4	Text Format

#### • Supported Video Formats

File Extension	Container	Video Codec	Resolution	Frame rate(Hz)	Bit rate(Mbps)	Audio Codec
*.mp4	MP4	DxV 3.11A, 12.5x6.0	1920x1080	6-30	20Mbps	MP3 / AAC /
		H.264	1920x1080	6-30	20Mbps	MP3 / AAC /
		VC1	1920x1080	6-30	20Mbps	MP3 / AAC /
		MPEG2	640x480	6-30	10Mbps	MP3 / AAC /
*.avi/.mkv	AVI/MKV	MPEG2 12.5x6.0	1920x1080	6-30	20Mbps	MP3 / AAC /
		H.264	1920x1080	6-30	20Mbps	MP3 / AAC /
		MPEG2	640x480	6-30	10Mbps	MP3 / AAC /
		DxV 3.11A, 12.5x6.0	1920x1080	6-30	20Mbps	MP3 / AAC /
*.mp3/.wma	ASF	MPEG2 12.5x6.0	1920x1080	6-30	20Mbps	MP3 / AAC /
		H.264	1920x1080	6-30	20Mbps	MP3 / AAC /
		MPEG2	640x480	6-30	10Mbps	MP3 / AAC /
		DxV 3.11A, 12.5x6.0	1920x1080	6-30	20Mbps	MP3 / AAC /
*.1080p1080p	TS	MPEG2 TS	1920x1080	6-30	20Mbps	AAC / AAC /
		H.264	1920x1080	6-30	20Mbps	MP3 / AAC /
		MPEG2	1920x1080	6-30	20Mbps	MP3 / AAC /
		MPEG2	1920x1080	6-30	20Mbps	MP3 / AAC /
*.divx.mpeg/mpeg.vob	PS	H.264	1920x1080	6-30	20Mbps	AAC / MPEG /
		MPEG2	1920x1080	6-30	20Mbps	MP3 / AAC /
		H.264	1920x1080	6-30	20Mbps	MP3 / AAC /
		MPEG2	1920x1080	6-30	20Mbps	MP3 / AAC /
*.3gp	3GPP	H.264	1920x1080	6-30	20Mbps	MP3 / AAC /
		MPEG2	1920x1080	6-30	20Mbps	MP3 / AAC /
		H.264	1920x1080	6-30	20Mbps	MP3 / AAC /
		MPEG2	1920x1080	6-30	20Mbps	MP3 / AAC /
*.h264	h264	H.264	1920x1080	6-30	20Mbps	MP3 / AAC /
		MPEG2	1920x1080	6-30	20Mbps	MP3 / AAC /
		H.264	1920x1080	6-30	20Mbps	MP3 / AAC /
		MPEG2	1920x1080	6-30	20Mbps	MP3 / AAC /

#### • Supported Photo Formats

Image	Photo	Resolution
JPEG	Basic file	12800 x 8704
	Progressive	1024 x 768

### Other Restrictions

- Video content will not play, or not play correctly, if there is an error in the content or the container.
- Sound or video may not work if the contents have a standard bit rate/ frame rate above the compatible Frame/sec listed in the table above.
- If the Index Table is in error, the Seek (Jump) function is not supported.
- The menu may take longer to appear if the video's bit rate exceeds 10Mbps.
- Video content can not be played, if there are many contents in one file.

#### Video Decoder

Supports up to H.264, Level 4.1  
H.264 RVC / ASO / RS, VC1 SP / MP / AP L4 and AVCHD are not supported.  
MPEG4 SP, ASP :

- Below 1280 x 720: 60 frame max
- Above 1280 x 720: 30 frame max

H.263 is not supported.  
GMC is not supported.

#### Audio Decoder

Supports up to WMA7, 8, 9 STD, 9 PRO, 10 PRO  
WMA 9 PRO and WMA 10 PRO support 5.1 channel. (LBR mode of WMA Pro is not supported)  
WMA Lossless is not supported.

### ■ Music

- Press the ◀ or ▶ button to select **Music**, then press the ENTER button in the **Media Play** menu.
  - Press the ◀▶/▲/▼ buttons to select the desired Music in the file list.
  - Press the ENTER button or [▶] (Play) button.
    - During music playback, you can search using the ◀ and ▶ button.
    - [◀] (REW) and [▶] (FF) buttons do not function during play.
- Only displays the files with MP3 file extension. Other file extensions are not displayed, even if they are saved on the same USB device.
  - If the need to change **Equalizer** - when playing MP3, then exit **Media Play**, adjust the **Equalizer** in the **Sound** menu. (An over-modulated MP3 file may cause a sound problem.)

#### ■ Photos

- Press the ◀ or ▶ button to select **Photos**, then press the ENTER button in the **Media Play** menu.
  - Press the ◀▶/▲/▼ buttons to select the desired photo in the file list.
  - Press the ENTER button or [▶] (Play) button.
    - The photo is displayed on the top with its playing time.
- While a photo list is displayed, press the [▶] (Play) / ENTER button on the remote control to start the slide show.
  - All files in the file list section will be displayed in the slide show.
  - During the slide show, files are displayed in order.
  - During the slide show, you can adjust the slide show speed using [◀] (REW) or [▶] (FF) button.
  - You can move to other file using ◀ or ▶ button.

#### • Supported Photo Formats

Image	Photo	Resolution
JPEG	Basic file	12800 x 8704
	Progressive	1024 x 768

### Other Restrictions

CMYK, YCCOK Colour space JPEG are not supported.

#### ■ Playing Multiple Files

##### Playing selected video/music/photo files

- Press the Yellow button in the file list to select the desired file.

- Repeat the above operation to select multiple files.

##### NOTE

- The y mark appears to the left of the selected files.
- To cancel a selection, press the Yellow button again.
- To deselect all selected files, press the TOOLS button and select **Deselect All**.

##### ■ Playing the video/music/photo file group

While a file list is displayed, move to any file in desired group.

##### ■ Media Play - Additional Functions

##### Videos/Music/Photos Play Option menus

When playing a file, press the TOOLS button.

Category	Operation	Videos	Music	Photos
<b>Title</b>	You can move the other file directly.	✓		
<b>Repeat Mode</b>	You can play movie and music files repeatedly.	✓	✓	
<b>Picture Size</b>	You can adjust the picture size to your preference.	✓		
<b>Picture Mode</b>	You can adjust the picture setting.	✓		✓
<b>Sound Mode</b>	You can adjust the sound setting.	✓	✓	
<b>Subtitle Setting</b>	You can play the video with Subtitles. This function only works if the subtitles are the same file name as the video.	✓		
<b>Audio Language</b>	You can change the audio language if the video has more than one language.	✓		
<b>Stop Slide Show / Start Slide Show</b>	You can start or stop a Slide Show.			✓
<b>Slide Show Speed</b>	You can select the slide show speed during the slide show.			✓
<b>Zoom</b>	You can zoom into images in full screen mode.			✓
<b>Rotate</b>	You can rotate images in full screen mode.			✓
<b>Information</b>	You can see detailed information about the played file.	✓	✓	✓

### □ DivX® Video On Demand

Shows the registration code authorized for the TV. If you connect to the DivX web site and register with 10-digit registration code, you can download the VOD activation code. Once you play it using **Media Play**, the registration is completed.

- For more information on DivX® VOD, visit <http://vod.divx.com>.

### □ Using the Soccer Mode

#### Soccer Mode **[TOOLS]**

This mode provides optimised condition for watching sports games.

- [Zoom]:** Pause playback and dived the picture into 9 parts. Select a part to zoom it in. Press this button again to resume.

- When **Soccer Mode** is **On**, the picture and sound modes are set to **Stadium** automatically.

- If you turn the TV off while watching **Soccer Mode**, the **Soccer Mode** will be disable.

### □ Using the Screen&Sound Capture mode

#### Screen&Sound Capture mode **[\*]**

This mode provides a way to capture the images and audio.

Press [\*] and the **Screen&Sound Capture** mode will be turned on, or press MENU button, enter Support Menu select **Screen&Sound Capture**. Press [\*] again the **Screen&Sound Capture** mode will be turned off.

- Before enabling the **Screen&Sound Capture** mode, the USB device should be connected first.

- Media Play** mode not available.

#### Screen Capture

After turning on the **Screen&Sound Capture** mode, press [▶] to make a current screen capture.

Items are stored in **Photos** folder in **Media Play**.

- At least after 15 seconds the next capture can be operated again.

### Sound Recording

After turning on the **Screen&Sound Capture** mode, press [▶] to make a recording of the current sound, press [▶] again to stop the recording. Items are stored in **Music** folder in **Media Play**.

- If you press any key, Audio Recording will be stopped.

### View Content

Press [VIEW] to get into **Media Play**.

Press ◀ or ▶ button to select **Music** for items of recording or **Photos** for items of capturing.

- Screen&Sound Capture** are for personal use only, not for commercial purpose and/or communication to the public.

- The user may not use these features for commercial purposes without prior approval from the copyright owners and/or to use it unlawfully.
- Samsung does not accept responsibility for any misuse of the service.

### □ Software Upgrade

**Software Upgrade** can be performed by downloading the latest firmware from "www.samsung.com" to a USB memory device.

### □ HD Connection Guide

You can read a guide to connect external devices for HD sources.

### □ Contact Samsung

View this information when your TV does not work properly or when you want to upgrade the software. You can find information regarding our call centres, and how to download products and software.

## Other Information

### Installing the Wall Mount

The wall mount kit (sold separately) allows you to mount the TV on the wall. For detailed information on installing the wall mount, see the instructions provided with the wall mount. Contact a technician for assistance when installing the wall mount bracket.

Samsung Electronics is not responsible for any damage to the product or injury to yourself or others if you elect to install the TV on your own.

#### Wall Mount Kit Specifications (VESA)

- The wall mount kit is not supplied, but sold separately. Install your wall mount on a solid wall perpendicular to the floor. When attaching to other building materials, please contact your nearest dealer. If you install the TV on a ceiling or slanted wall, it may fall and result in severe personal injury.

- NOTE**
  - Standard dimensions for wall mount kits are shown in the table below.

- When purchasing our wall mount kit, a detailed installation manual and all parts necessary for assembly are provided.
- Do not use screws that do not comply with the VESA standard screw specifications.
- Do not use screws longer than the standard dimension, as they may cause damage to the inside of the TV set.
- For wall mounts that do not comply with the VESA standard screw specifications, the length of the screws may differ depending on the wall mount specifications.
- Do not fasten the screws too firmly. This may damage the product or cause the product to fall, leading to personal injury. Samsung is not liable for these kinds of accidents.
- Samsung is not liable for product damage or personal injury when a non-VESA or non-specified wall mount is used or the consumer fails to follow the product installation instructions.
- Do not mount the TV at more than a 15 degree tilt.
- Always have two people mount the TV on a wall.

Product Family	Models	VESA screw hole specs (A" B" in millimeters)	Standard Screw	Quantity
LED-TV	UA40H4200	200 X 200	M8	4
	UA48H4200			



### Securing the TV to the Wall

- Caution:** Pulling, pushing, or climbing onto the TV may cause the TV to fall. In particular, ensure that your children do not hang over or destabilize the TV, doing so may cause the TV to tip over, resulting in serious injuries or death. Follow all safety precautions provided on the included Safety Flyer. For added stability, install the anti-fall device for safety purposes, as follows.

#### To prevent the TV from falling

- Since the necessary clamps, screws, and string are not supplied, please purchase these additionally.
- Put the screws into the clamps and firmly fasten them onto the wall. Confirm that the screws have been firmly installed onto the wall.

- You may need additional material such as an anchor depending on the type of wall.

- Remove the screws from the back Centre of the TV, put the screws into the clamps, and then fasten the screws onto the TV again.

- NOTE**
  - Screws may not be supplied with the product. In this case, please purchase the screws of the following specifications.

- Connect the clamps fixed onto the TV and the clamps fixed onto the wall with a strong cable and then tie the string tightly.
  - Note**
    - Install the TV near to the wall so that it does not fall backwards.
    - It is safe to connect the string so that the clamps fixed on the wall are equal to or lower than the clamps fixed on the TV.
    - Untie the string before moving the TV.
- Verify all connections are properly secured. Periodically check connections for any sign of fatigue for failure. If you have any doubt about the security of your connections, contact a professional installer.

### Kensington Lock

The Kensington Lock is not supplied by Samsung. It is a device used to physically fix the system when using it in a public place. Refer to the manual provided with the Kensington Lock for additional information on proper use.

- Please find a "Ⓚ" icon on the rear of the TV. The Kensington slot is beside the "Ⓚ" icon.
- The position and colour may differ depending on the model.

- To lock the product, follow these steps:**
  - Wrap the Kensington lock cable around a large, stationary object such as desk or chair.
  - Slide the end of the cable with the lock attached through the looped end of the Kensington lock cable.
  - Insert the locking device into the Kensington slot on the product.
  - Lock the lock.

- These are general instructions. For exact instructions, see the User manual supplied with the locking device.
- The locking device has to be purchased separately.
- The location of the Kensington slot may be different depending on the TV model.

### Troubleshooting

If you have any questions about the TV, first refer to this list. If none of these troubleshooting tips apply, please visit "www.samsung.com," then click on Support, or contact the call centre listed on the back-cover of this manual.

Problem	Possible Solution
<b>Picture Quality</b>	
The TV image does not look as good as it did in the store.	<ul style="list-style-type: none"><li>If you have an analogue cable/set top box, upgrade to a digital set top box. Use HDMI or Component cables to</li></ul>